

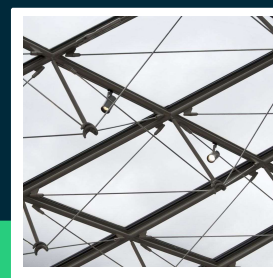

**20W LED COB tracklight with CREE CHIP CCT:3000K black body 6yrs warranty**

SKU 241546 EAN 3800170254350 VT-11122

Related products (SKUs): ---

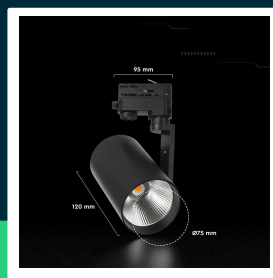
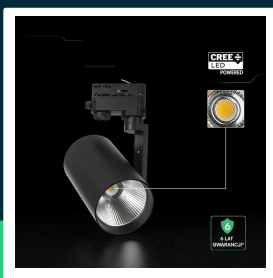
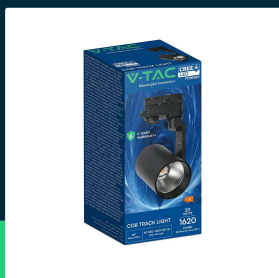
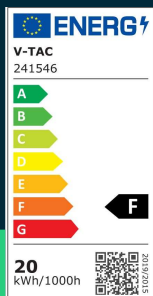

## TECHNICAL SPECIFICATION

|                    |                        |                      |                           |                 |               |
|--------------------|------------------------|----------------------|---------------------------|-----------------|---------------|
| Power              | 20W                    | Frequency            | 50/60Hz                   | Pack width      | 90 mm         |
| Luminous flux (lm) | 1620 lm                | Power factor         | >0.7                      | Pack height     | 220 mm        |
| Light color        | Warm white             | CRI                  | 80+                       | Master carton   | 20            |
| Color temperature  | 3000K                  | Material             | Aluminium                 | Brand           | V-TAC         |
| Beam angle         | 20°                    | IK rating            | IK03                      | Warranty        | 6y            |
| Voltage            | 230V                   | Housing color        | Black                     | Certifications  | CE, EMC, ROHS |
| SKU                | SKU 241546             | Type                 | 3-phase track system 230V | Efficacy (lm/W) | 80 lm/W       |
| EAN barcode        | 3800170254350          | Dimming              | NIE                       | ETIM            | EC001959      |
| Product code       | VT-11122               | IP rating            | IP20                      | CN code         | 8539 51 00    |
| Series             | Lighting track rails   | Rotation             | TAK                       | EPREL           | 2455682       |
| Energy class       | F                      | Ignition time (100%) | 0.001s                    |                 |               |
| Base               | Integrated LED fixture | On/Off cycles        | >20000                    |                 |               |
| Shape              | Round                  | Size                 | 205x95x75mm               |                 |               |
| LED module type    | CREE LED               | Product weight       | 0,47                      |                 |               |
| Lifetime           | 30000h                 | Volume               | 0,00235                   |                 |               |
| Input voltage      | AC:220-240V, 50Hz      | Pack length          | 102 mm                    |                 |               |



**20W LED COB tracklight with CREE CHIP CCT:3000K black body 6yrs warranty**

SKU 241546 EAN 3800170254350 VT-11122

Related products (SKUs): ---

## Product description

- 6-year warranty
- A new generation of luminaires with CREE chip technology, ensuring high reliability
- CREE LED is a global leader in LED technology with over 35 years of experience, 1800 patents, and exceptional performance, durability and precision
- Compatible with all popular rail systems such as UTS, POWER GEAR, Global Track, A.A.G. Stucchi, Nordic Aluminum, Unipro etc
- High luminous efficiency and uniform color rendering
- CRI above 80 ensures realistic color reproduction
- Narrow beam angle 20° for precise accent lighting
- Compact design with the ability to adjust the angle of light incidence
- Solid casing made of aluminum
- Easy installation in 4-core busbar trunking systems
- Integrated driver and durable construction
- High durability and stable operation

## GPSR Information

- Manufacturer: V-TAC Europe Ltd. Address: bul. "Rozhen" 41, 1271 Sofia, Bulgaria, office@v-tac.eu
- Importer: V-TAC Europe Ltd. Address: bul. "Rozhen" 41, 1271 Sofia, Bulgaria, office@v-tac.eu
- Distributor and importer in Poland: Led Europe Sp. z o.o. Address: ul. Starorudzka 12E 93-491 Łódź, Poland, biuro@led-europe.pl
- Documents confirming compliance of products with applicable safety standards are available on the website [www.v-tac.eu](http://www.v-tac.eu). If the required documentation is not available, please contact the local distributor: [biuro@led-europe.pl](mailto:biuro@led-europe.pl)
- If you have any problems with the product, contact the distributor in Poland: [biuro@led-europe.pl](mailto:biuro@led-europe.pl)
- Country of production: China